

# JKS®

## Installation Instructions

Product: Telescoping Trackbar™

Part Number: PN 9800

Application: Jeep® Wrangler YJ, 1987-95

### Welcome

CONGRATULATIONS on purchasing a new Telescoping Trackbar™ from JKS Manufacturing. We are committed to providing you with the best products available and your satisfaction is our first priority.

PLEASE READ these Installation Instructions carefully, and save them for future reference, as they contain important installation and maintenance information.

### Important

**COMPATIBLE WITH** the front of 1987-95 Wrangler YJ models only. Do not attempt to modify or install this product on any other application or location.

**NOT COMPATIBLE WITH** coil-spring conversion systems.

**NEVER UNLOCK TRACKBAR** when operating vehicle on public roads.

**CHECK TORQUE SPECIFICATIONS** regularly.

### Tools Required

- Metric/Standard Socket Wrench Set
- Torque Wrench
- 1-1/8" and 9/16" Open-End Wrenches
- Drill with 1/2" Drill Bit
- Grease Gun with Zerk Fitting Coupler
- Wheel Bearing Grease
- Welder \*

\* Asterisk denotes tools that are not required for some applications. Thoroughly read instructions first to determine which tools will be required for your application.

### Parts

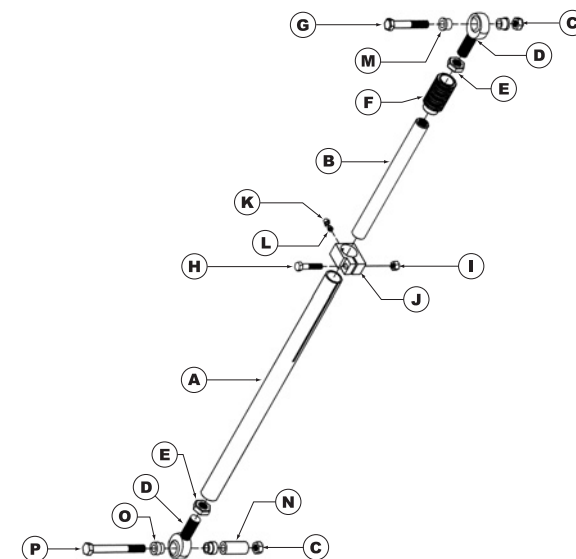

<b>A</b>	Outer Tube (Chassis End)
<b>B</b>	Slip Shaft (Axle End)
<b>C</b>	1/2" Ovalok Nut
<b>D</b>	3/4" Teflon Lined Rod End
<b>E</b>	3/4" Jam Nut
<b>F</b>	Polyurethane Dust Boot
<b>G</b>	1/2" x 3" GR8 Bolt
<b>H</b>	3/8" x 1-3/4" GR8 Bolt
<b>I</b>	3/8" Nylock Nut
<b>J</b>	Clamp
<b>K</b>	Grease Zerk Cap
<b>L</b>	Grease Zerk
<b>M</b>	1/8" Shoulder Spacer (narrow)
<b>N</b>	1.85" OE Bracket Spacer
<b>O</b>	5/16" Shoulder Spacer (wide)
<b>P</b>	1/2" x 4-1/2" GR8 Bolt

## Installation

### ❑ 1. REMOVE ORIGINAL EQUIPMENT (OE) FRONT TRACK BAR

- Remove front track bar and mounting hardware – including U-bracket from chassis – according to the factory service manual instructions for your vehicle.
- Also remove any aftermarket track bar relocation or riser bracket from axle, if installed. Such parts are commonly supplied with suspension lift kits.

**IMPORTANT:** It will be necessary for the OE pitman arm to be installed on the steering box if aftermarket relocation/riser bracket is removed from the axle. However, if special circumstances require the relocation/riser bracket to be retained, it will also be necessary to retain the drop pitman arm.

### ❑ 2. MOUNT TELESCOPING TRACKBAR TO CHASSIS BRACKET

- Insert 1.85" Spacer (N) into chassis rail bracket where the OE track bar originally mounted.  
**HINT:** The 1.85" Spacer (marked with an "X") prevents the OE bracket from collapsing.
- Insert a 5/16" (wide) Shoulder Spacer (O) into each side of the Rod End (D) at the Chassis End (A) of Telescoping Trackbar.  
**HINT:** The Shoulder Spacers must "sandwich" the Rod End to allow full flexibility of the joint when installed.

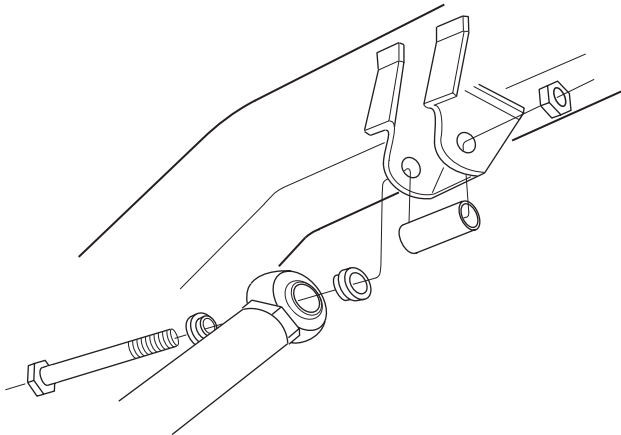

- Mount Chassis End (A) of trackbar behind the chassis rail bracket and secure with the 1/2" x 4-1/2" Bolt (P) and 1/2" Ovalok Nut (C).  
**HINT:** When installed correctly, Grease Zerk (L) will point up and JKS decal will face forward.
- Tighten 1/2" x 4-1/2" Bolt (P) to 75 ft-lb. using a torque wrench.

### ❑ 3. MOUNT TELESCOPING TRACKBAR TO AXLE BRACKET

- Using a 1/2" drill bit, enlarge the hole on the axle where the OE track bar originally mounted.
- Insert a 1/8" (narrow) Shoulder Spacer (M) into each side of Rod End (D) at the Axle End (B) of Telescoping Trackbar. **HINT:** Shoulder Spacers must "sandwich" the Rod End to allow full flexibility of the joint when installed.
- Mount Axle End (A) of trackbar to axle bracket and secure with a 1/2" x 3" Bolt (G) and 1/2" Ovalok Nut (C).
- Tighten 1/2" x 3" Bolt (G) to 75 ft-lb. using a torque wrench.

### ❑ 4. TIGHTEN TELESCOPING TRACKBAR

- With the vehicle on a level surface, tighten the Clamp (J) using a 9/16" wrench.
- Tighten the 3/4" Jam Nuts (E) located at each end of the trackbar, but DO NOT thread out Rod Ends (D).

**IMPORTANT:** Rod Ends have been properly installed from the factory. Avoid unthreading Rod Ends prior to installation, as this may sacrifice strength.

### ❑ 5. LUBRICATE TELESCOPING TRACKBAR

- Lubricate the Grease Zerk (L) located on the Clamp (J) of Telescoping Trackbar using common wheel bearing grease or equivalent.

## Operation

Telescoping Trackbar should remain in the "locked" position when vehicle is operated on public roads. Once off-road, the trackbar can be "unlocked" by loosening the Clamp (J) using a pair of 9/16" wrenches.

## Troubleshooting

If slippage occurs on Chassis End of Telescoping Trackbar, weld the 1.85" OE Bracket Spacer (N) in place.

## Maintenance

Telescoping Trackbar is factory lubricated, but should be greased regularly as part of vehicle maintenance schedule.

Regular cleaning with pressurized water is recommended to maximize ease of operation and reliability. Always lubricate afterwards to evacuate any moisture.

Check torque specifications regularly.

© 2009 JKS Manufacturing, Inc & Aftermarketing, LLC  
Revision Date 8/6/2009