



Installation Instructions TrekStep Side-Mount™

Vehicle Application

- Toyota Tundra Double Cab – Driver Side
6.5' Bed
2007 – Current
Part Number: 75409-15

www.bestop.com - We're here to help! Visit our web site and click on "[Ask a Question](#)". Click here for more [Truck Accessories by Bestop](#).

INSTALLATION TIME



1/2 Hour

SKILL LEVEL



1 - Easy

TOOLS



Ratchet

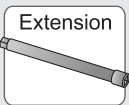

Extension

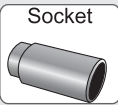

Socket

17mm,
13mm, 10mm

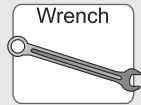

Wrench

10 mm and
17 mm



Safety
Glasses



WARNING

Do not rely in any way on the components of this product to protect against injury or death in the event of an accident. Never operate the vehicle in excess of manufacturer's specifications.

WEAR SEAT BELTS AT ALL TIMES

Read and follow, precisely, all installation instructions provided when installing product. Failure to do so may result in a poor fit and could place occupants of the vehicle in a potentially dangerous situation.

TrekStep Side-Mount™ – Installation Instructions

Parts List and Hardware Identification

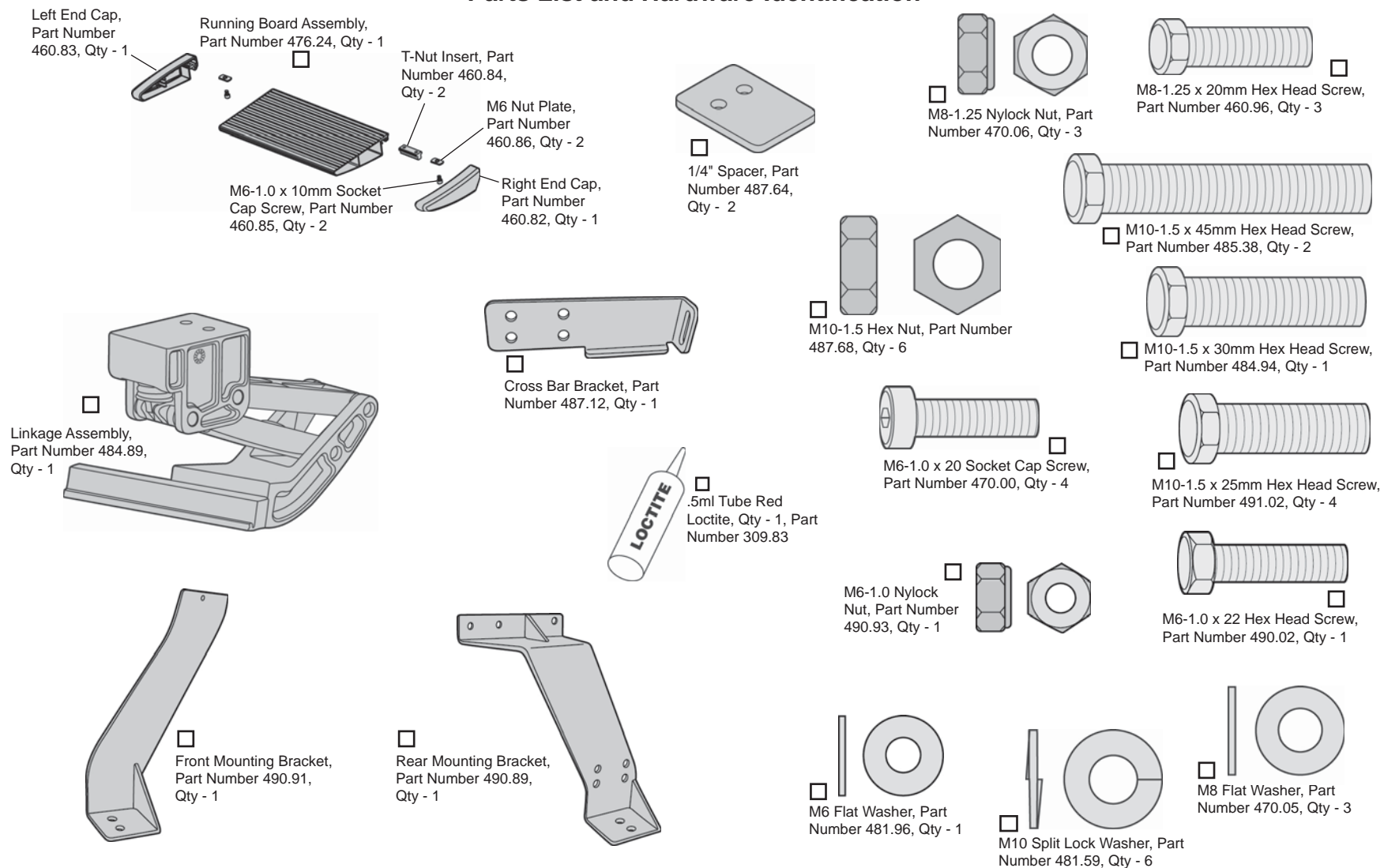

TrekStep Side-Mount™ – Installation Instructions

1 Install Rear Mounting Bracket

Locate the flange with three (3) holes that points down in front of the rear wheel. Line up the holes in the Rear Mounting Bracket with the holes in the flange.

Put a drop of Loctite on the threads of three (3) M8-1.25 x 20mm Hex Head Screws. Use them to install the Rear Mounting Bracket to the flange with M8 Flat Washers and M8-1.25 Nylock Nuts.

Leave the fasteners loose.

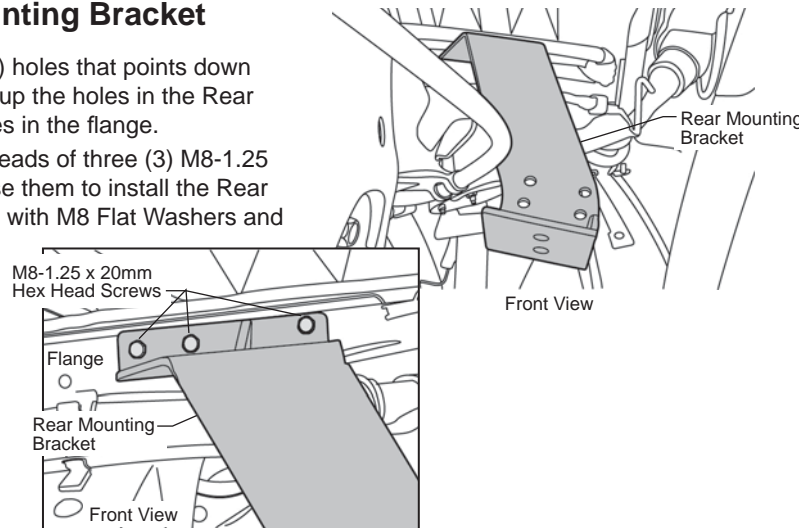

2 Assemble Cross Bar Bracket

Thread an M10-1.5 Hex Nut about two thirds of the way onto the M10-1.5 x 30mm Hex Head Screw. Insert the screw into the slot in the Cross Bar Bracket and thread another M10-1.5 Hex Nut on to the screw. Leave loose for later adjustment.

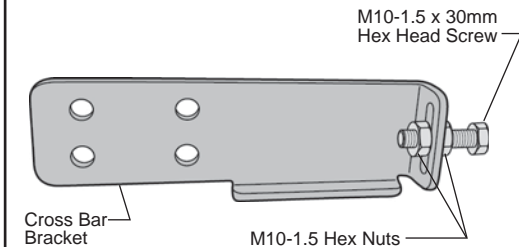

3 Install Cross Bar Bracket on Rear Mounting Bracket

Put a drop of Loctite on the threads of four (4) M10-1.5 x 25mm Hex Head Screws.

Orient the Cross Bar Bracket on the Rear Mounting Bracket as shown.

Secure the Cross Bar Bracket to the Rear Mounting Bracket with the four (4) M10-1.5 x 25mm Hex Head Screws, M10 Split Lock Washers and M10-1.5 Nylock Nuts.

Tighten the fasteners securely.

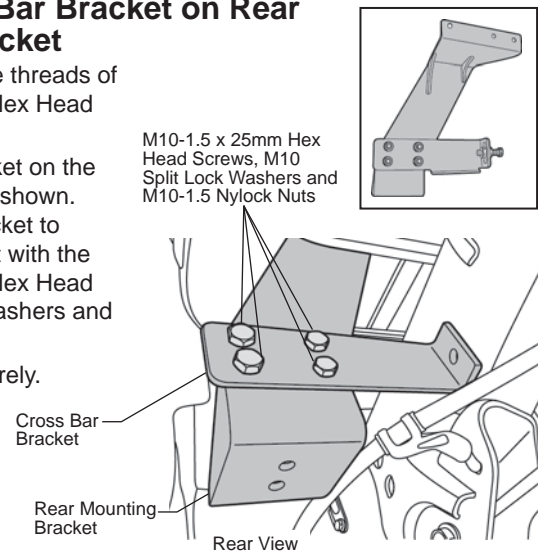

4 Install Front Mounting Bracket

Locate the flange with one (1) hole that points down in front of the Rear Mounting Bracket. Set the Front Mounting Bracket on top of the Rear Mounting Bracket and line up the hole in the bracket with the hole in the front side of the flange.

Put a drop of Loctite on the threads of the M6-1.0 x 22mm Hex Head Screw. Use it to install the Front Mounting Bracket to the flange with the M6 Flat Washer and M6-1.0 Nylock Nut.

Leave the fasteners loose.

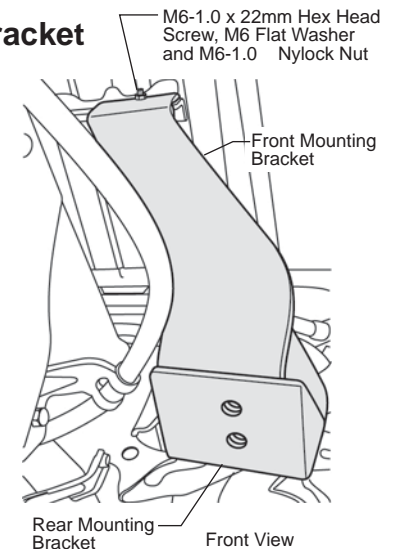

TrekStep Side-Mount™ – Installation Instructions

5 Install Linkage

Put a drop of Loctite on the threads of two (2) M10-1.5 x 45mm Hex Head Screws. Thread the screws with M10 Split Lock Washers through both brackets and into the Linkage. Tighten the bolts securely. Fully tighten the fasteners installed in Steps 1 and 3.

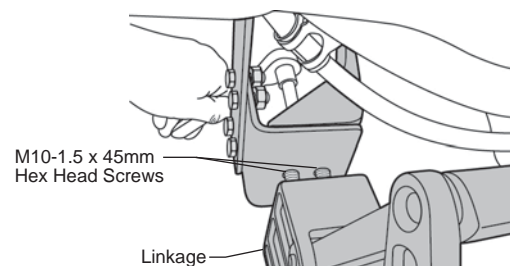

6 Secure Cross Bar

Adjust the Inboard nut on the M10 X 30mm Hex Head Screw on the Cross Bar Bracket until the head of the screw is tight against the frame. Put a drop of Loctite on the threads of the screw and tighten the outboard nut tight against the bracket.

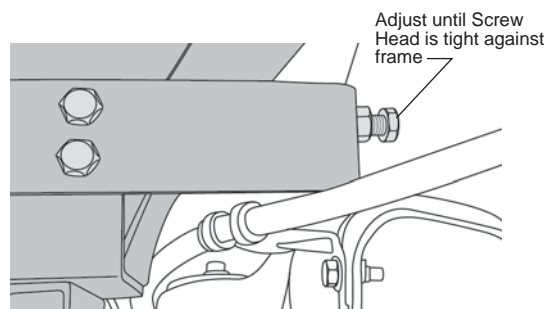

7 Install Step

Use the M6-1.0 x 20 Socket Head Cap Screws to mount the Step to the Linkage Assembly.

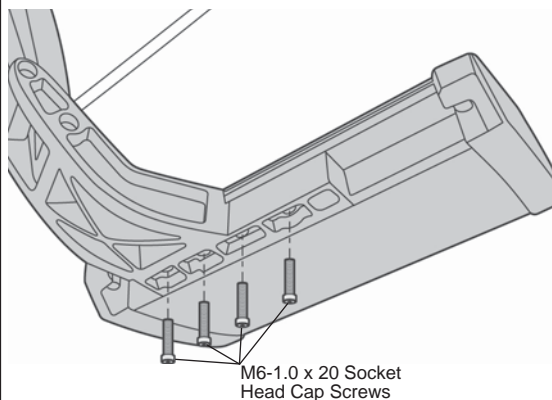

8 Step Adjustment

Once the Step is installed on the vehicle, you may adjust it as desired.

If necessary to adjust the height, use the two (2) 1/4" Spacers provided. Remove the M10-15 x 45mm Hex Bolts installed in Step 4 and place the 1/4" Spacers between the Frame Mount and the Linkage. Reinstall the Hex Bolts.

When the Step is in the desired position tighten all nuts.

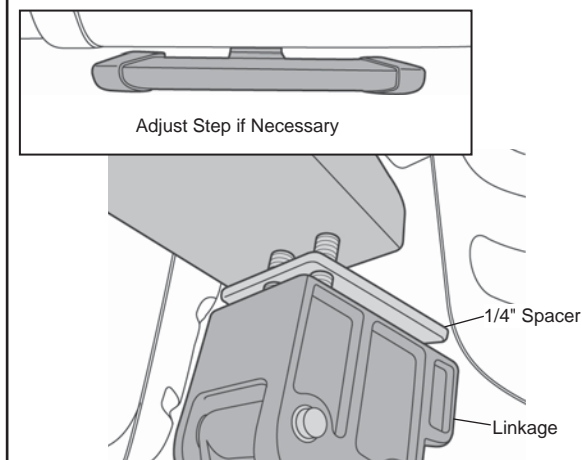

TrekStep Side-Mount™ – Installation Instructions

Operation

- The TrekStep™ is foot operated and deploys and retracts with a nudge of your foot.
- To deploy, press down using your foot, on the forward outside corner of the step pad.
- To retract, gently kick the underside of the step pad.
- Max Load Capacity: 400 lbs.
- Always use appropriate hand holds when stepping up to or down from your truck's cargo bed.

Maintenance Tips

The step pad surface and linkage arms can be washed with mild soap and water using a soft brush or sponge to dislodge any mud, dirt or accumulated road grime. Rinse with fresh water.
To prevent slipping, avoid applying waxes, lubricants or protectants like Armor All® to the step surface.

Attention!

TrekStep™ SHOULD ALWAYS BE STOWED IN THE RETRACTED POSITION WHEN DRIVING.

LIMITED WARRANTY

We warrant our product to be free from defects in material and workmanship, for the terms specified below, provided there has been normal use and proper maintenance. This warranty applies to the original purchaser only. All remedies under this warranty are limited to the repair or replacement of any item or items found by the factory to be defective within the time period specified. If you have a warranty claim, first you must call our factory at the number below for instructions. You must retain proof of purchase and submit a copy with any items returned for warranty work. Upon completion of warranty work, if any, we will return the repaired or replaced item or items to you freight prepaid. Damage to our products caused by accidents, fire, vandalism, negligence, misinstallation, misuse, Acts of God, or by defective parts not manufactured by us, is not covered under this warranty.

THE WARRANTY TIME PERIOD IS AS FOLLOWS FOR ALL TrekSteps™ MANUFACTURED BY OUR COMPANY: THREE YEARS / 36,000 MILES FROM DATE OF PURCHASE.

ANY IMPLIED WARRANTIES OF MERCHANTABILITY AND/OR FITNESS FOR A PARTICULAR PURPOSE CREATED HEREBY ARE LIMITED IN DURATION TO THE SAME DURATION AND SCOPE AS THE EXPRESS WRITTEN WARRANTY. OUR COMPANY SHALL NOT BE LIABLE FOR ANY INCIDENTAL OR CONSEQUENTIAL DAMAGE.

Some states do not allow limitations on how long an implied warranty lasts, or the exclusion or limitation of incidental or consequential damages, so the above limitations or exclusions may not apply to you. This warranty gives you specific legal rights, and you may also have other rights which vary from state to state.



For further information or request for warranty work, please contact:
Bestop Inc. Customer Service
Toll-Free: (800)845-3567
Main: (303)465-1755
E-mail: csbestop@Bestop.com
Website: www.Bestop.com