



## Roll Bar Storage Bag Set Up Guide

The correct attachment of this product is critical and beyond the control of Rightline Gear. The safe use and long life of this product depends entirely on your good judgment and following these directions.

### Pack The Roll Bar Storage Bag

**1-**Place items like towels, blankets, jackets, hats, clothing, first aid kits, lunch/snacks, sun screen, and tool kits in the main compartment and close its zipper (Fig 1, A).

**2-**Place smaller items in the pocket and close its zipper (Fig 1, B).

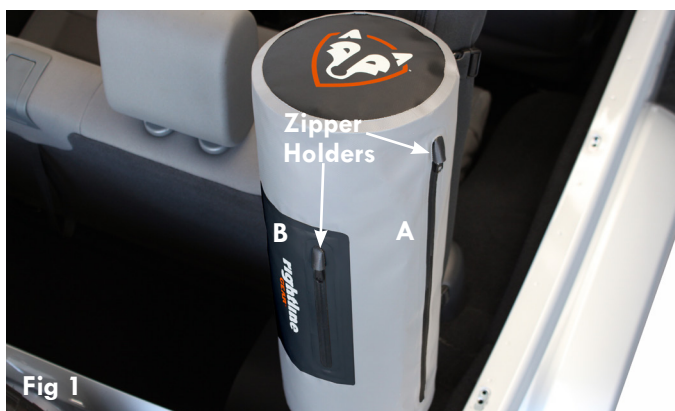

### Attach The Roll Bar Storage Bag

The Roll Bar Storage Bag straps to the vertical roll bars in 2-door and 4-door Jeep Wranglers. Your Wrangler's top can be up or down. This product fits the Jeep Wrangler CJ, YJ, TJ, and JK.

**1-**Position the bag so that its zipper holders are located at the top of the bag (Fig 1).

**2-**Buckle the bottom strap around the roll bar, without twisting the strap (Fig 2).

**3-**Buckle the top strap around the roll bar, without twisting the strap (Fig 3).

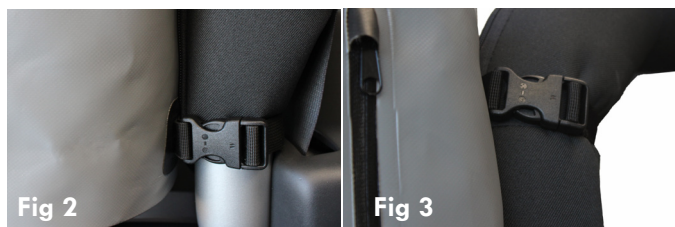

**4-**Stretch the bag along the roll bar and tighten both straps (Fig 4).

**5-**Move the tri-glides towards the loose ends of the straps (Fig 5).



[www.rightlinegear.com](http://www.rightlinegear.com)

### LIMITED WARRANTY

Rightline Gear warrants that for one (1) year, from the date of purchase that all products will be free of material defect and Rightline Gear will repair or replace any defective or damaged product free of charge if it is returned in original condition by the consumer to Rightline Gear or the place of purchase. Claims of defective material and/or workmanship must be made in a timely manner. Safe and maintenance-free use of this product depends upon the consumer's or user's proper installation of the product and good judgment in its use. Rightline Gear is not responsible for the consumer's or user's use or misuse of this product. Damage to Purchaser's vehicle or any other vehicle caused by Purchaser's improper use of this product may cause serious injury or death. The Purchaser acknowledges that Rightline Gear has no control over the attachment of its products to vehicles or the attachment of items to the Rightline Gear products. Accordingly, Rightline Gear cannot assume responsibility for any damage to any property arising out of the improper attachment or use of its products.

RIGHTLINE GEAR SPECIFICALLY DISCLAIMS ANY AND ALL OTHER WARRANTIES WHETHER EXPRESS OR IMPLIED, INCLUDING BUT NOT LIMITED TO WARRANTY OF MERCHANTABILITY AND WARRANTY OF FITNESS FOR A PARTICULAR PURPOSE. RIGHTLINE GEAR FURTHER DISCLAIMS ANY WARRANTY OR OTHER PROMISE THAT GIVES RISE TO ANY SORT OF CONSEQUENTIAL, EXTRAORDINARY, PUNITIVE, EXEMPLARY, SUBSEQUENT, OR NONECONOMIC DAMAGES OR ATTORNEY FEES. THE CONSUMER OR USER'S SOLE REMEDY AGAINST RIGHTLINE GEAR FOR ANY DEFECT IN THIS PRODUCT IS LIMITED TO FULL RETURN OF THE PURCHASE PRICE.

**RIGHTLINE GEAR SPECIFICALLY ENCOURAGES COMPLIANCE WITH ALL MOTOR VEHICLE LAWS, AND EXPRESSLY DISCLAIMS ANY AND ALL LIABILITY FOR FAILURE TO COMPLY WITH SAME.**