



SIGNATURE SERIES
JL JEEP
ROCK RAILS

**INSTALLATION
INSTRUCTIONS**

***PLEASE READ THROUGH THE INSTRUCTIONS BEFORE BEGINNING ANY PART OF THE
INSTALLATION PROCESS***

WEB LINK: <http://lodoffroad.com/assets/pdfs/JRS1841INS.pdf>

1.



Remove the stock rock sliders (if included on vehicle)

The rock sliders mount in the shown areas.

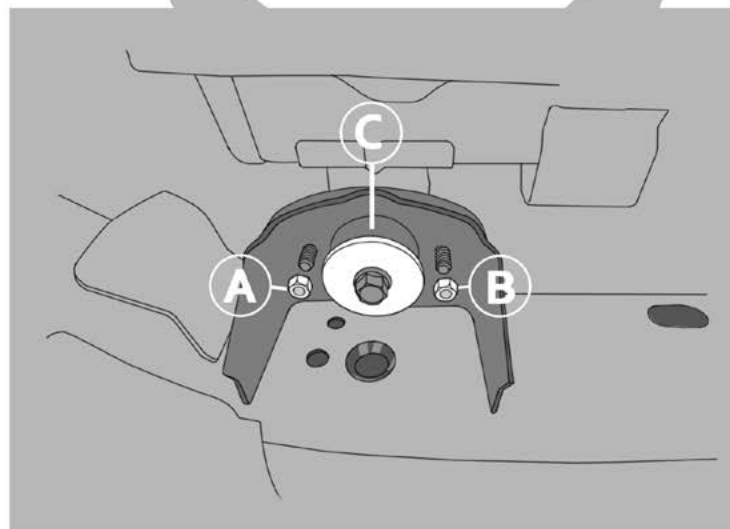
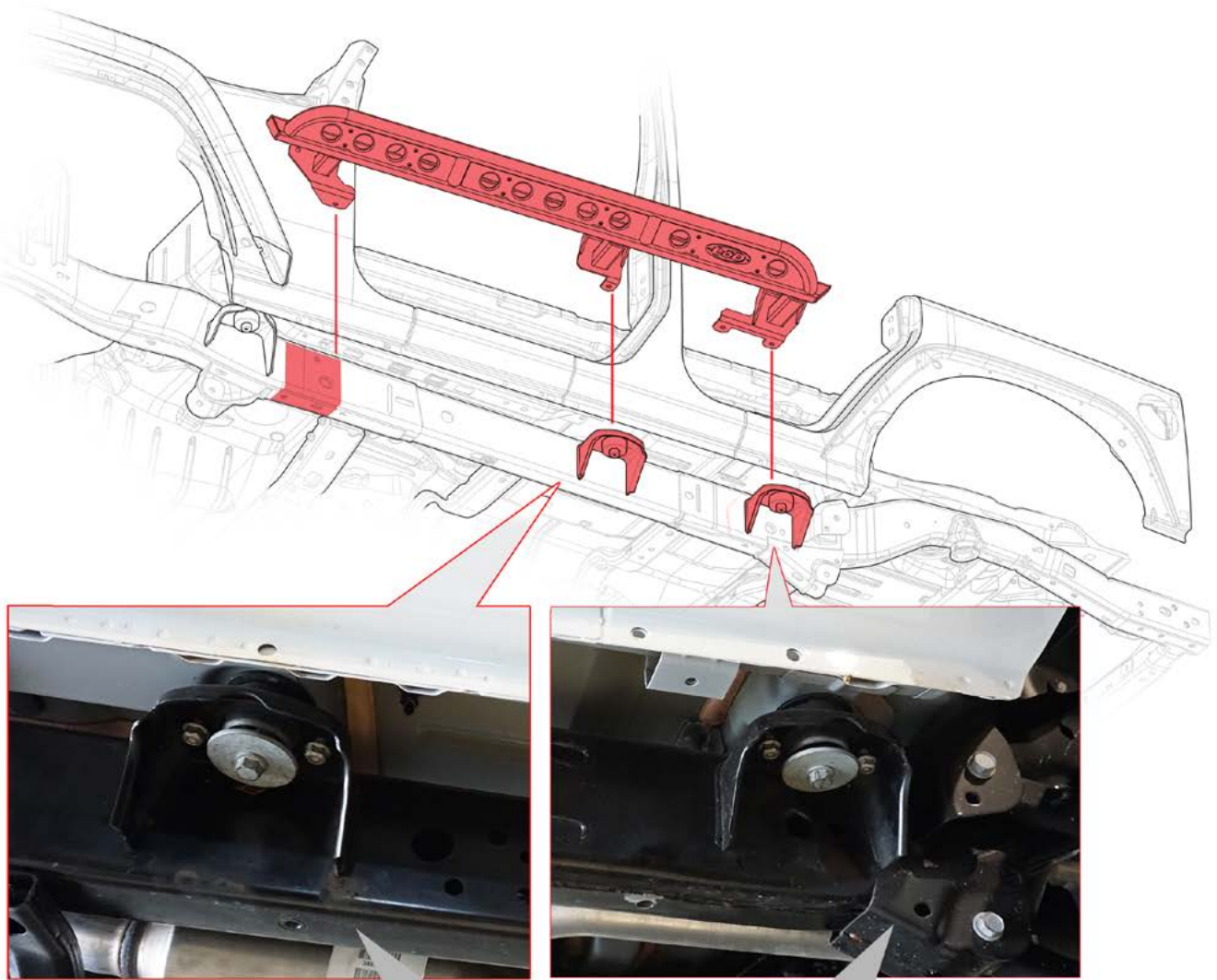

Remove the nuts in position "A" and "B."
"C" stays in place.

FRONT MOUNT - (PASS. SIDE SHOWN)



Insert the flag nut into the rectangle hole to match with the bolt inserted in position "A".
The hole at location "B" is optional, but it recommended for heavy-duty off-road use.

Mark the hole location, then use a **9/16"** drill bit (passenger side only - driver side has a hole)



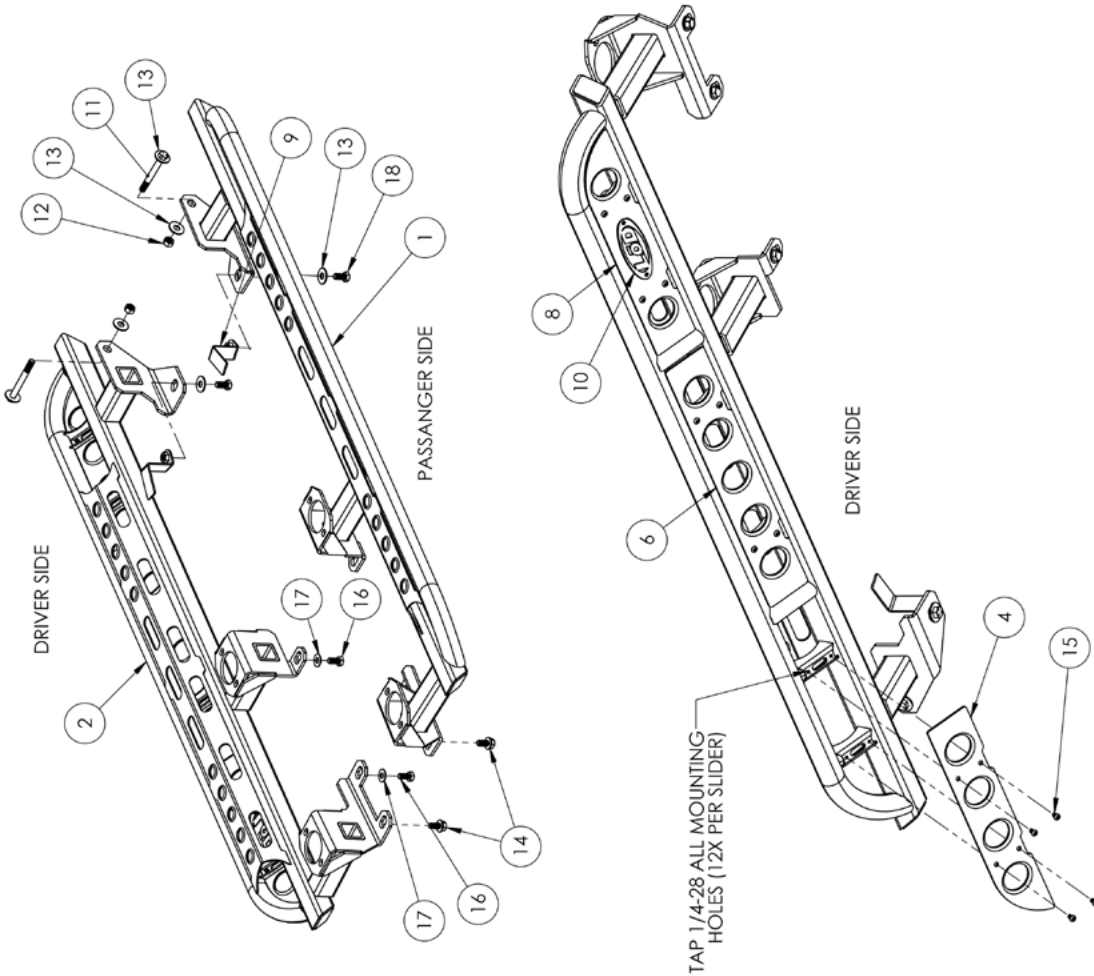

ITEM NO.	PART NUMBER	FINISH	DESCRIPTION	QTY.
1	4JRS1840-05	BS / BP	SIG SLIDER PASS SIDE WELDMENT	1
2	4JRS1840-06	BS / BP	SIG SLIDER DRIVER SIDE WELDMENT	1
3	2JRS1840-07	BS / BP	SIGNATURE LOWER FRONT COVER PLATE	1
4	2JRS1840-21	BS / BP	SIGNATURE LOWER FRONT COVER PLATE	1
5	2JRS1840-08	BS / BP	SIGNATURE LOWER MIDDLE COVER PLATE	1
6	2JRS1840-22	BS / BP	SIGNATURE LOWER MIDDLE COVER PLATE	1
7	2JRS1840-09	BS / BP	SIGNATURE LOWER REAR COVER PLATE	1
8	2JRS1840-23	BS / BP	SIGNATURE LOWER REAR COVER PLATE	1
9	THN5013ZPGR5-02		TABBED HEX NUT 1/2-13 ZINC PLATE GR5	2
10	LOD Logo		Logo	2

HARDWARE

ITEM NO.	PART NUMBER	FINISH	DESCRIPTION	QTY.
11	HB501372ZPGR5		HEX BOLT 1/2-13 X 4.50 HEX BOLT ZINC PLATE GR5	2
12	HN5013ZPGR5		HEX NUT 1/2-13 ZINC PLATE GR5	2
13	FW5022ZP		FLAT WASHER Ø1/2" X 1.375" ZINC PLATED	6
14	TR501316ZP		THREAD ROLLER 1/2-13 X 1.00 HEX ZINC PLATE	2
15	BHSCS252808SS		BHSCS 1/4-28 X 0.50 STAINLESS STEEL	24
16	HB12150M25ZPCL88		HEX BOLT M12-1.50 x 25mm ZINC PLATE Cl8.8	2
17	FW4318ZP		FLAT WASHER Ø7/16 X 1.25" ZINC PLATED	2
18	HB501316ZPGR5		HEX BOLT 1/2-13 X 1.00 HEX BOLT ZINC PLATE GR5	2

FINISH CODE:
BS = BARE STEEL OPTION / BP = BLACK POWDER COAT OPTION

NOTES:

1. JRS1840 = BARE STEEL OPTION
2. JRS1841 = BLACK POWDER COAT OPTION

SIGNATURE SERIES FRAME MOUNTED
4 DOOR ROCK SLIDERS

JRS18-SEE NOTES



JL Jeep
Signature Series
 Rock Sliders
 Hardware + Ship Sheet
 Packaged by:

_____ On: _____

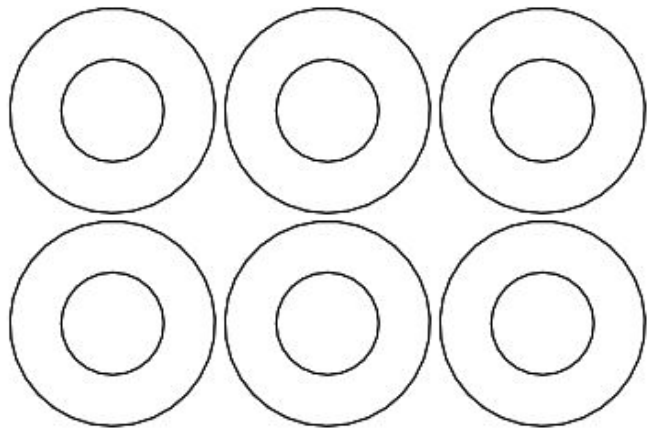

1/2" (13) x 1.375"
 Washer
(x 6)

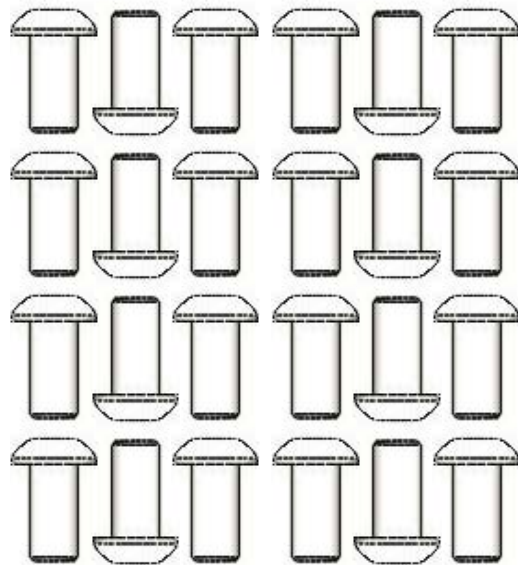
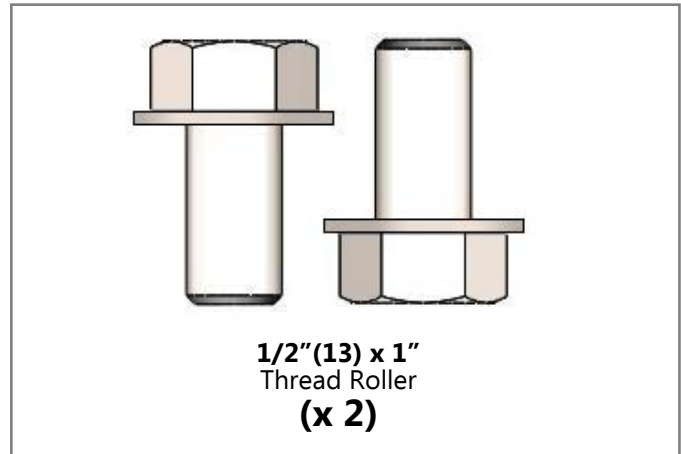
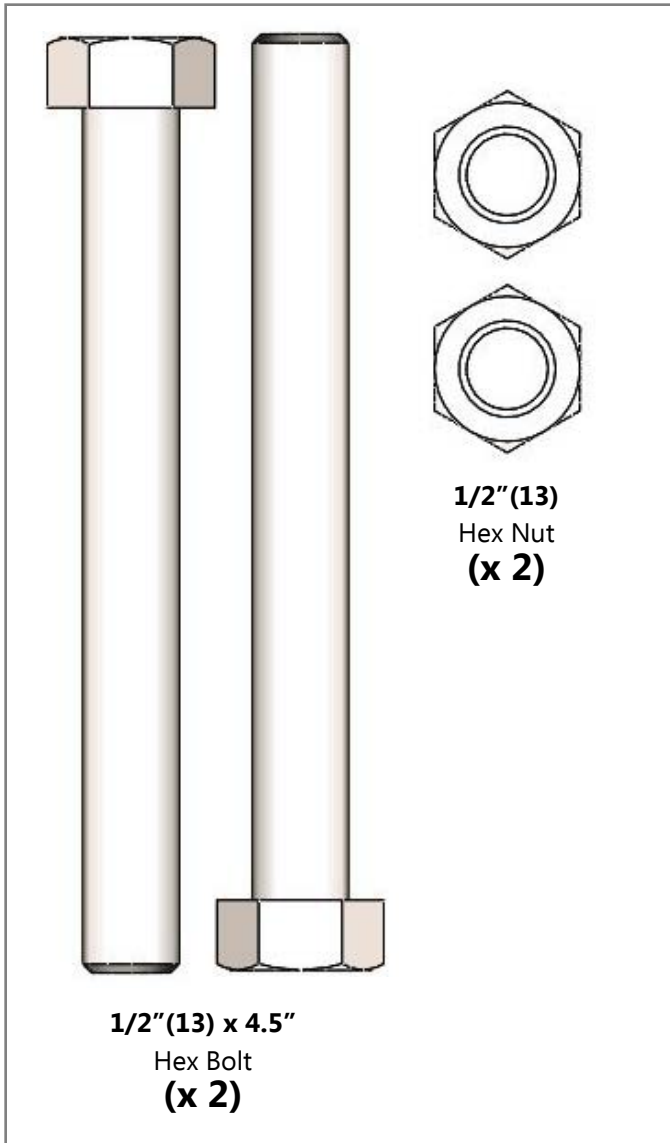

1/4" (20) x 0.5"
 Buttonhead Bolts
(x 24)

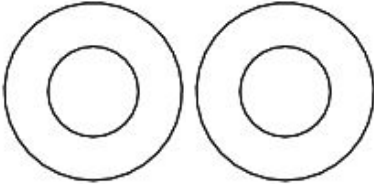
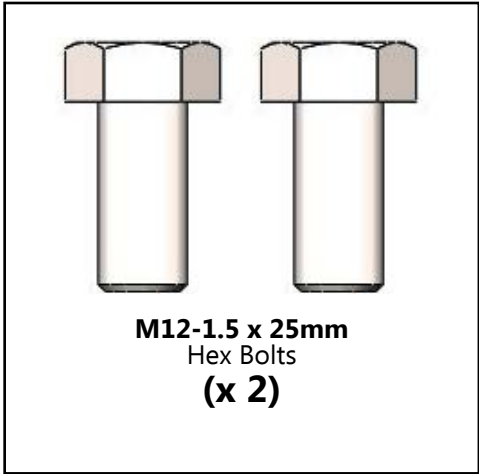

7/16"
Flat Washers
(x 2)

